

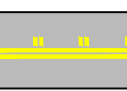



The contractor is responsible for the verification of dimensions on the site. All dimensions are in millimetres. © Copyright all rights reserved South Tyneside Council. Distance Survey data has been reproduced from Mastermap with the permission of The Controller of H.M. Stationery Office. Crown copyright reserved. Licence No. 100019670

**KEY**

-  Proposed No Waiting / No Loading At Any Time
-  Existing No Waiting / No Loading At Any Time
-  Proposed Permit Holders Only Mon-Sat 8am to 6pm
-  Proposed 2 Hours Limited Waiting Mon-Fri 8am to 6pm

**S1**

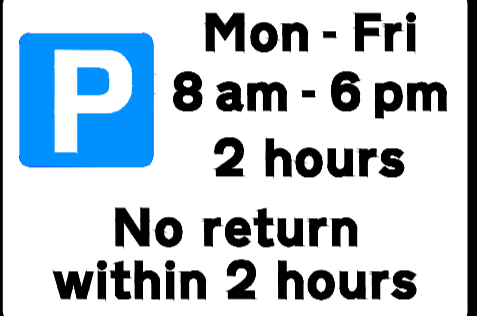
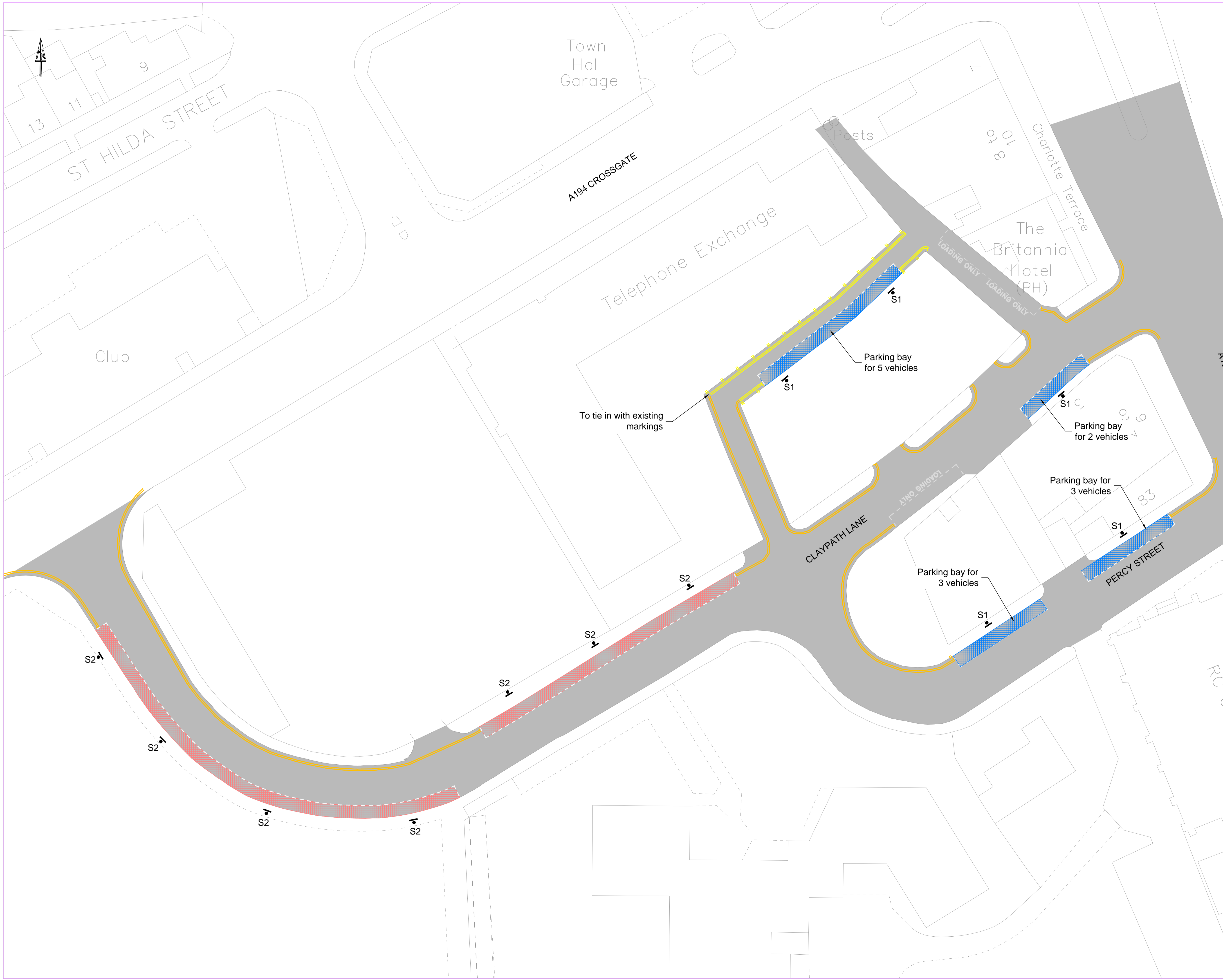

**S2**

Rev	Date	Description	Chkd

**South Tyneside Council**  
Economic Regeneration

Town Hall & Civic Offices, Westoe Road, South Shields, Tyne & Wear, NE33 2RL  
Telephone: (0191) 427 1717 Fax: (0191) 455 7770

Project: Claypath Lane / Percy Street South Shields

Drawing Title: Proposed Parking Restrictions

Drawn by	SB	Date	07/04/20
Checked by	XX	Date	--/--
Scale	NTS	Size	A1
Project Code	Drawing Number		
T1-07/2020			